

HADLEIGH
RESIDENTIAL



ENGLAND'S LANE, NW3

£403 PW/£1750 PCM

TOP FLOOR OF A PERIOD CONVERSION | STYLISH INTERIORS THROUGHOUT | BRIGHT RECEPTION WITH WOODEN FLOORS | OPEN PLAN CONTEMPORARY KITCHEN | TWO GENEROUSLY PROPORTIONED DOUBLE BEDROOMS | LOTS OF NATURAL LIGHT | BRAND NEW LUXURY BATHROOM



For clarification, we wish to inform prospective tenants that we have prepared these particulars as a general guide. We have not carried out a detailed survey, nor tested the services, appliances and specific fittings. Room sizes should not be relied upon for carpets and furnishings. If there are any important matters which are likely to affect your decision, please contact us before viewing the property.

HADLEIGH RESIDENTIAL
19 BELSIZE GROVE, LONDON, NW3 4TX
020 7722 9799
PROPERTY@HADLEIGH.CO.UK | WWW.HADLEIGH.CO.UK

DESCRIPTION

A well presented two bedroom apartment occupying the top floor of this well maintained period conversion in an excellent position on England's Lane. With stylish interiors throughout the property comprises a lovely bright reception room with stunning open plan kitchen, two generously proportioned double bedrooms and brand new contemporary bathroom.

Offered furnished and available immediately.

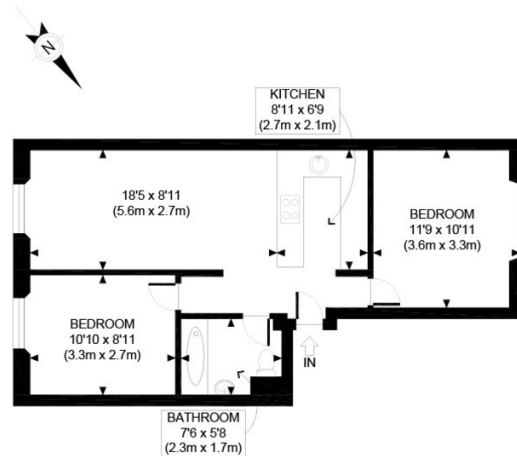

SECOND FLOOR
GROSS INTERNAL
FLOOR AREA 549 SQ FT

APPROX. GROSS INTERNAL FLOOR AREA 549 SQ FT / 51 SQM

Ref: Copyright **photoplan**

Disclaimer: Floor plan measurements are approximate and are for illustrative purposes only. While we do not doubt the floor plan accuracy and completeness, you or your advisors should conduct a careful, independent investigation of the property in respect of monetary valuation

ENERGY EFFICIENCY RATING C.