



ENGLANDS LANE, **NW3**

£800 PW/£3467 PCM

BEAUTIFULLY PRESENTED SPLIT LEVEL APARTMENT | OCCUPYING TOP TWO FLOORS OF PERIOD PROPERTY | GENEROUSLY PROPORTIONED THROUGHOUT | 1161 SQ. FT. | STUNNING RECEPTION ROOM WITH TERRACE | ROOF TERRACE WITH SPECTACULAR VIEWS ACROSS THE CITY | TWO GENEROUSLY PROPORTIONED BEDROOMS

For clarification, we wish to inform prospective tenants that we have prepared these particulars as a general guide. We have not carried out a detailed survey, nor tested the services, appliances and specific fittings. Room sizes should not be relied upon for carpets and furnishings. If there are any important matters which are likely to affect your decision, please contact us before viewing the property.

HADLEIGH RESIDENTIAL
19 BELSIZE GROVE, LONDON, NW3 4TX
020 7722 9799
PROPERTY@HADLEIGH.CO.UK | WWW.HADLEIGH.CO.UK

DESCRIPTION

A beautifully presented two bedroom split level apartment over the top two floors of this period property on England's Lane with south facing roof terrace offering spectacular views over the City. The apartment provides 1161 sq ft comprising of a generously proportioned reception room with contemporary open plan kitchen which both occupy the entire top floor of this impressive property, large master bedroom with luxury en suite bathroom, further double bedroom which has use of an additional family bathroom and study area. The apartment has wooden floors and stylish interiors throughout and is available from the end of March on an unfurnished basis.

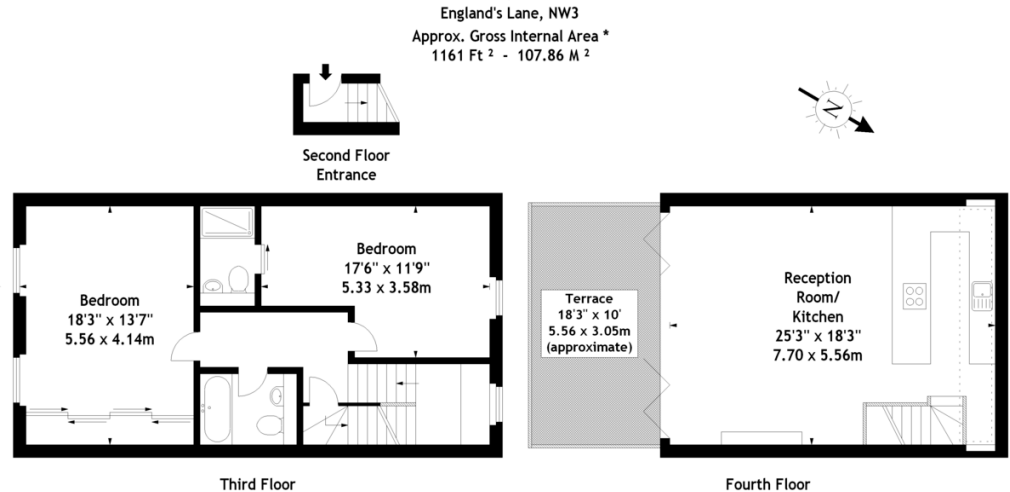

Illustration For Identification Purposes Only. Not To Scale
* As Defined by RICS - Code of Measuring Practice
© International Floorplans.
Tel 0034 115 345958
www.ifpl.it

ENERGY EFFICIENCY RATING C.