

HADLEIGH
RESIDENTIAL



ANTRIM ROAD, NW3

£3,500 PCM

GENEROUSLY PROPORTIONED THROUGHOUT | ATTRACTIVE RED BRICK MANSION BLOCK | 1015 SQ. FT. | THREE BEDROOMS | STRIPPED WOOD FLOORS THROUGHOUT | KITCHEN WITH RANGE COOKER AND DISHWASHER | LOVELY COMMUNAL GARDENS

For clarification, we wish to inform prospective tenants that we have prepared these particulars as a general guide. We have not carried out a detailed survey, nor tested the services, appliances and specific fittings. Room sizes should not be relied upon for carpets and furnishings. If there are any important matters which are likely to affect your decision, please contact us before viewing the property.

HADLEIGH RESIDENTIAL
19 BELSIZE GROVE, LONDON, NW3 4TX
020 7722 9799
PROPERTY@HADLEIGH.CO.UK | WWW.HADLEIGH.CO.UK

DESCRIPTION

A generously proportioned three bedroom apartment over the ground floor of this attractive red brick mansion building in the heart of Belsize Park with Englands Lane on your doorstep. The property provides over 1,000 sq. ft. comprising of a lovely bay fronted reception room with feature fireplace, generous size kitchen which leads directly out to communal gardens, three bedrooms all with feature fireplaces and a family bathroom with bath and walk in shower cubicle. The apartment has stripped wood floors throughout and is available unfurnished from the end of February.

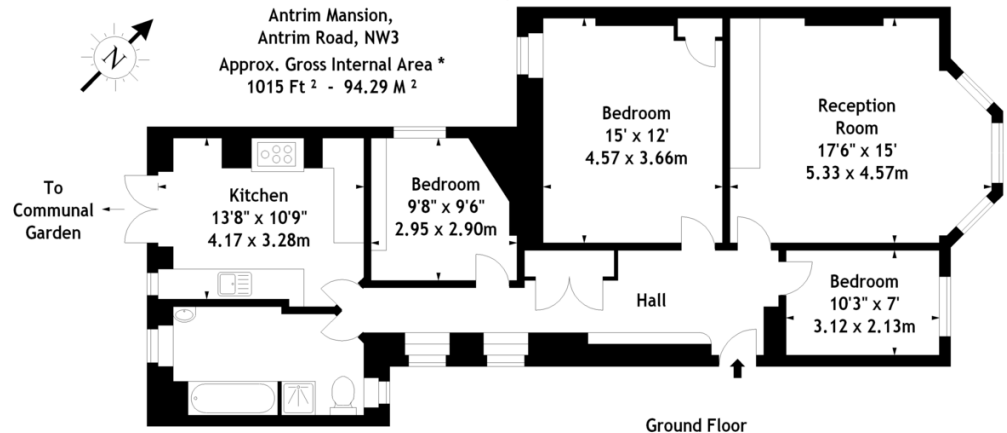

Illustration For Identification Purposes Only. Not To Scale
* As Defined by RICS - Code of Measuring Practice
© International Floorplans.
Tel 0094 115 345958
www.ifpl.co.uk

ENERGY EFFICIENCY RATING D.